

220/110V 24 Way 1PH Panelboard  
Typical To All Apartments

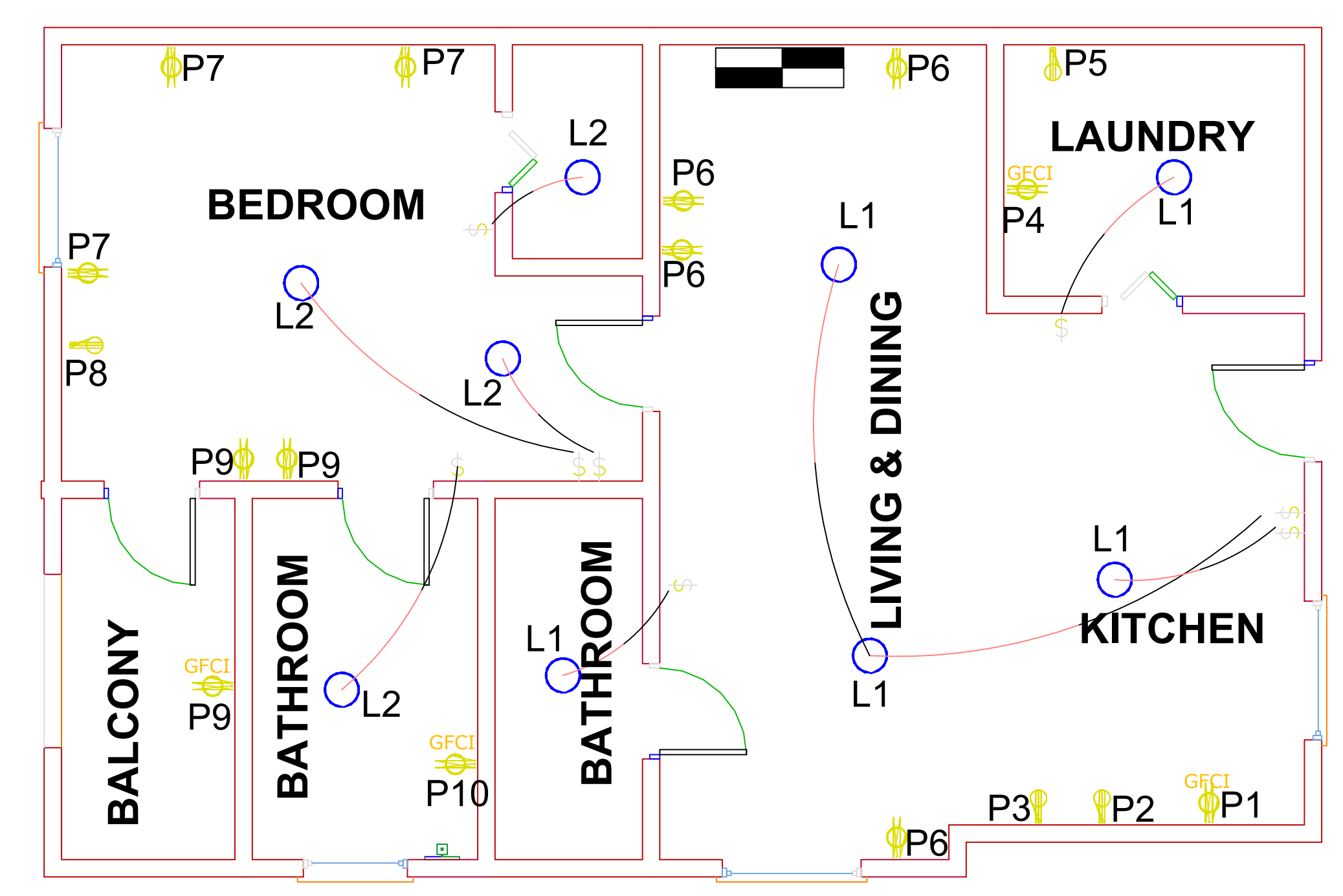

TYPICAL FLOOR PLAN LAYOUT OF APTS

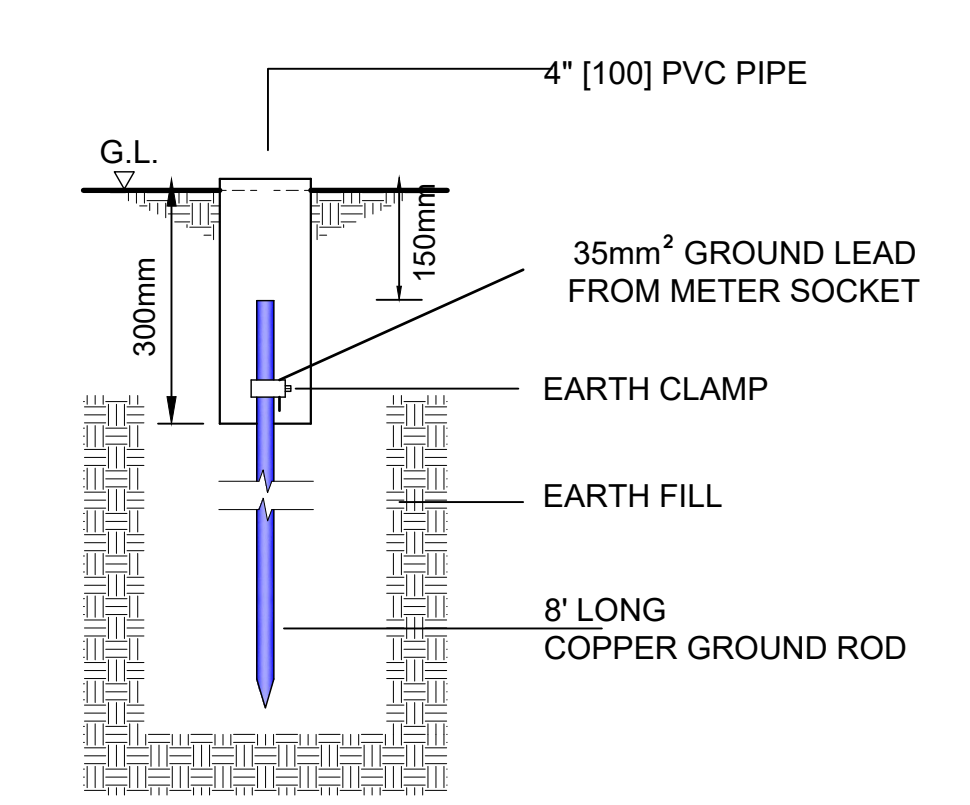

EARTHING ARRANGEMENT  
Typical To All Apartments

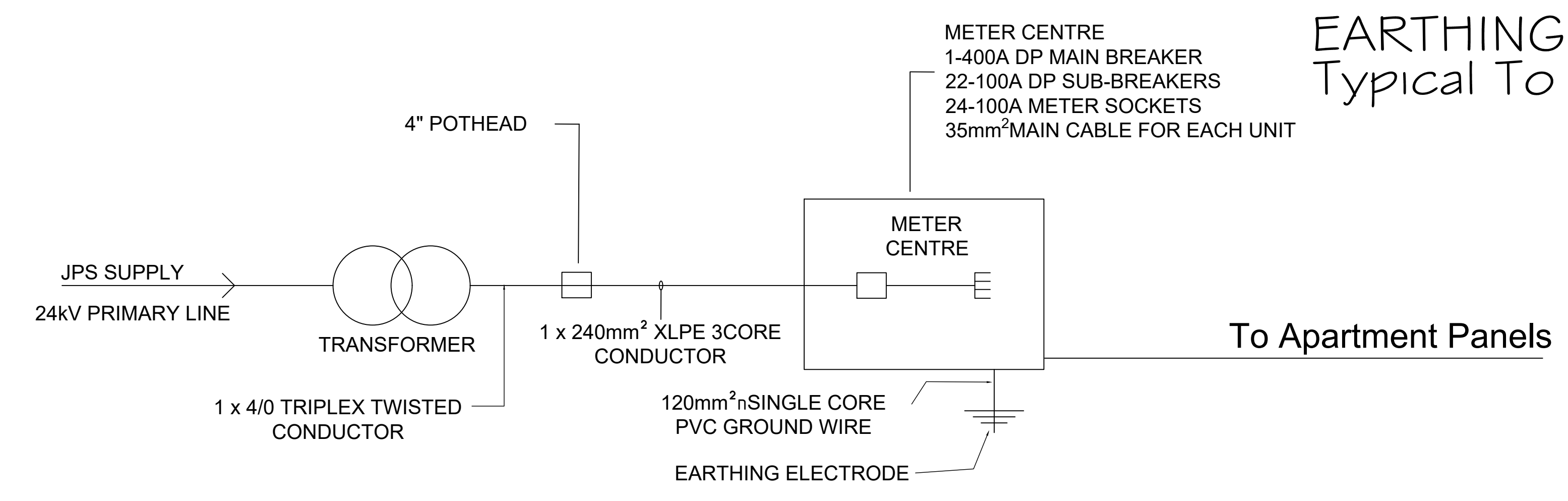

ONE LINE DIAGRAM

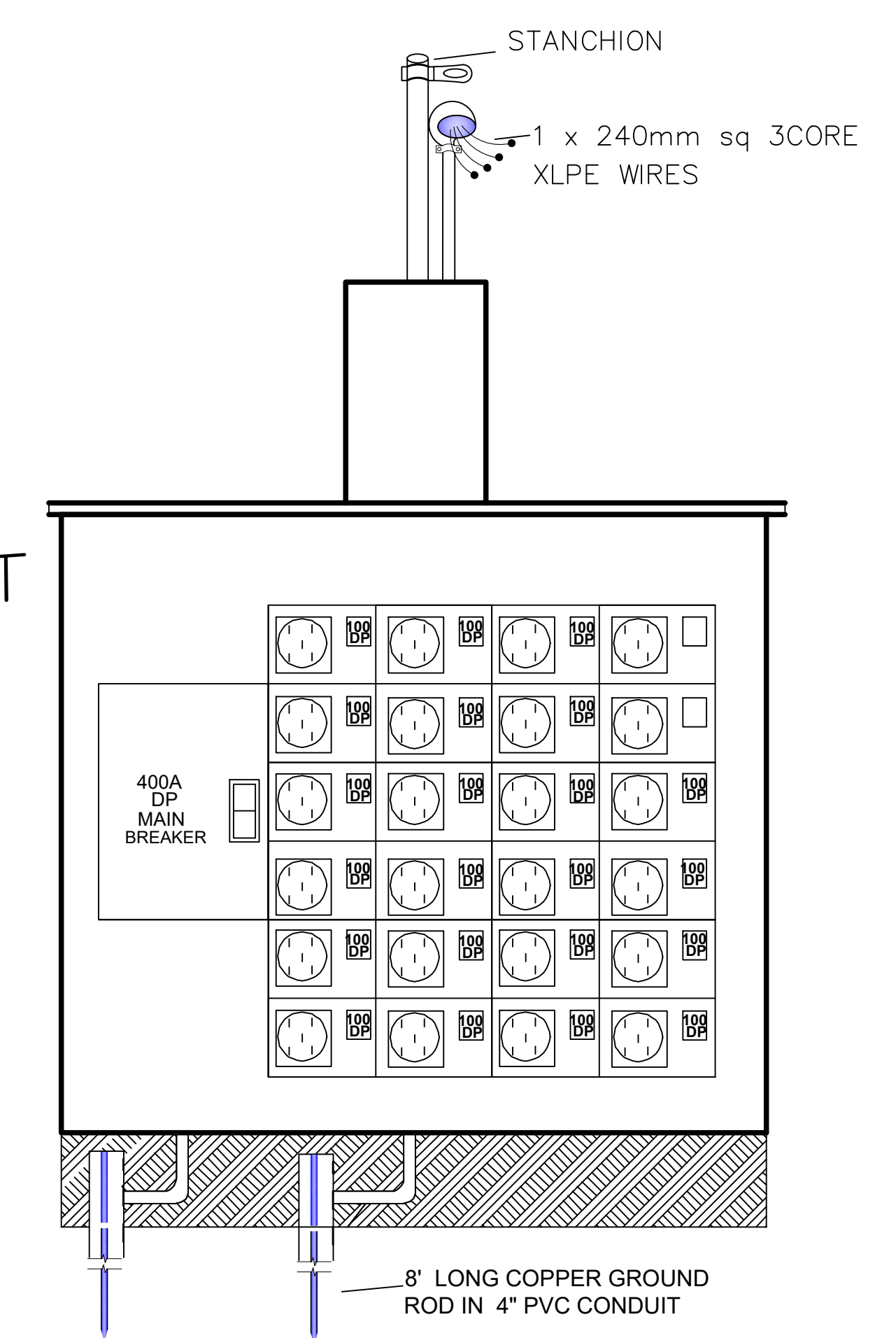

METER CENTER ARRANGEMENT

LEGEND	
	110V Duplex Con. Outlet
	GFCI 110V Duplex Con. Outlet
	220V Outlet
	110V Single Pole Switch
	Main Distribution Panel
	110V Ceiling Light Fixture
	110V Weatherproof Light Fixture

- INSTALLATION NOTES**
- ALL CONVENIENT OUTLET MUST BE MINIMUM 18" FROM FLOOR LEVEL.
  - ALL SWITCHES SHOULD BE PLACED MINIMUM 4' 6" FROM FLOOR LEVEL.
  - ALL CONVENIENT OUTLET WITHIN 3' OF SINK, TUB OR BASIN MUST BE OF GFCI TYPE & BREAKER.
  - POTHEAD MUST BE INSTALLED AT A MINIMUM HEIGHT OF 15' FROM GROUND LEVEL.
  - METER SOCKET MUST BE LOCATED WITH 5' OF THE PREMISES BOUNDARY.
  - A TAG SHALL BE ATTACHED TO GROUND ROD SHOWING "DANGER DO NOT DISCONNECT"
- THE REQUIRED DIVERSITY FACTOR WAS USED TO CALCULATE THE TOTAL LOAD DEMAND.
- 90% OF THE TOTAL CONNECTED LIGHTING POINTS
  - 100% OF THE CURRENT RATING OF THE LARGEST CIRCUIT BREAKER PLUS 50% OF THE SUM OF THE SUM OF THE CIRCUIT RATINGS OF THE REMAINING CIRCUIT BREAKER.

**ROHAN MCLEAN**  
Registered Electrician  
Email: rohanmclean75@gmail.com  
Cell: (876) 818-4353

Client name & address:  
Fritzwanen Rodgers  
22 East Kings House Rd  
Kingston 5

Project Electrical Design	DRAWING #: FR-06-22
Date JUN 2022	
Scale N.T.S.	